



Joining Zoho Assist for remote support – this will enable your helper to see and control your computer temporarily.

To start:

Go onto the internet and type “join.zoho.eu” in the address bar

You will then be asked for the Session Id which I will tell you over the phone or by email.

Type in your name

Click “Join Session”

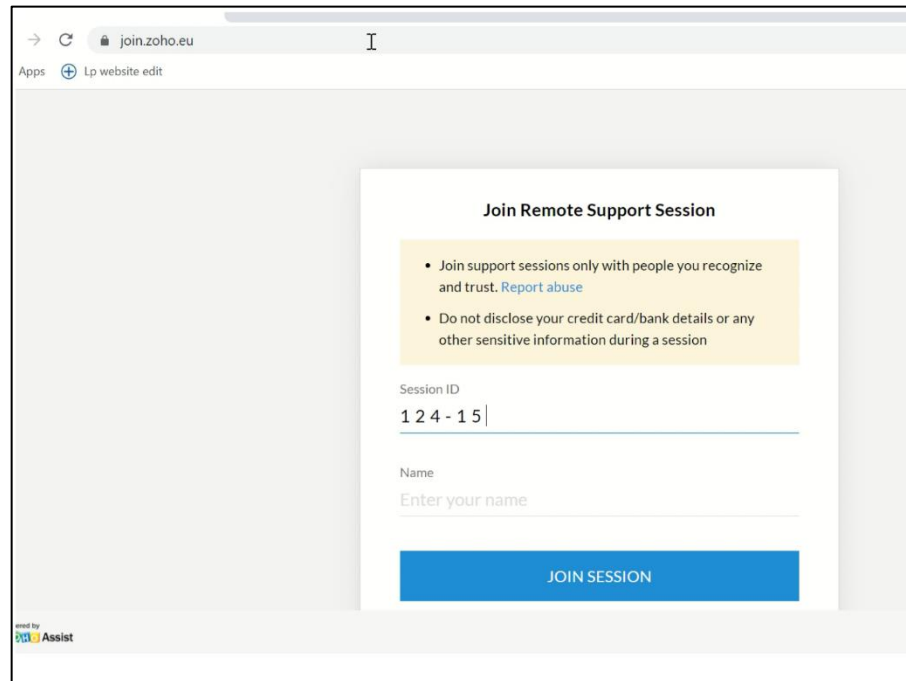

Once it has downloaded double click to initiate

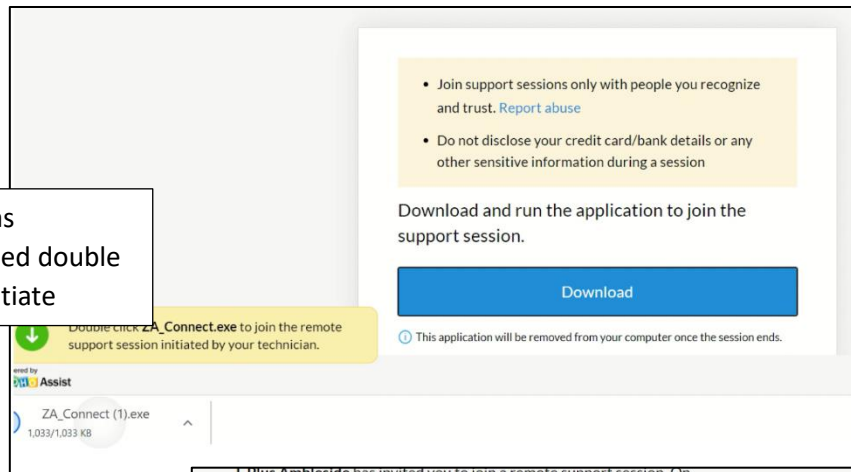

You will then see this screen and need to click “Download”

When it opens you will see the Zoho Assist box appear in the bottom right corner and be asked to join.

Click “Join” and the status will change to “In Session” once connection has been made.

